



SERVICE PARTS LIST

BULLETIN NO.
54-05-0826

SPECIFY CATALOG NO. AND SERIAL NO. WHEN ORDERING PARTS		REVISED BULLETIN 54-05-0825	DATE Feb. 2014
D.I. VARIABLE TEMP. HEAT GUN with Display			
CATALOG NO.	8988-20	SERIAL NUMBER	199B
		WIRING INSTRUCTION See Reverse Side	

EXAMPLE:
Component Parts (Small #) Are Included
When Ordering The Assembly (Large #).

★ = Part number change from
previous service parts list.

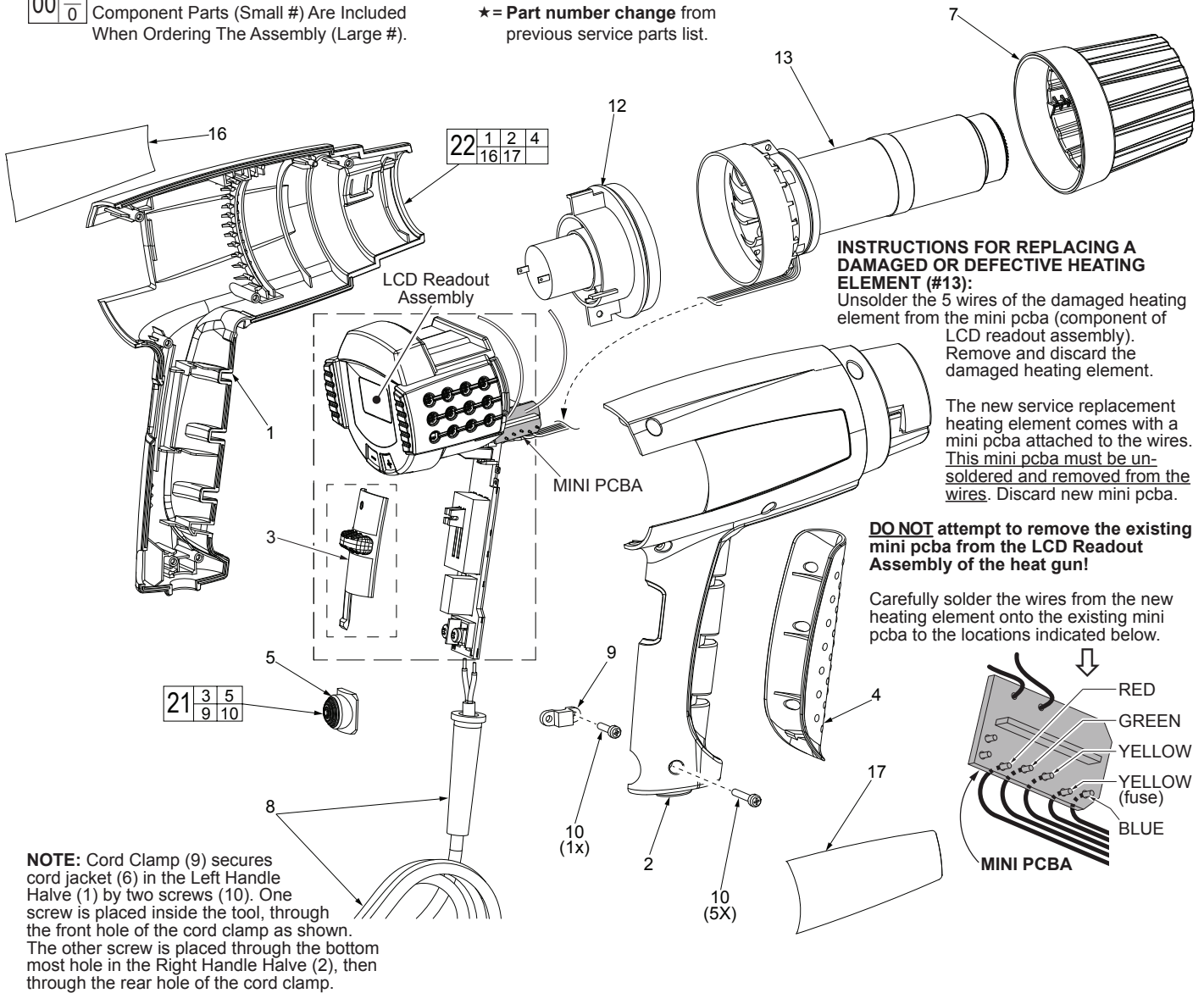

INSTRUCTIONS FOR REPLACING A DAMAGED OR DEFECTIVE HEATING ELEMENT (#13):
Unsolder the 5 wires of the damaged heating element from the mini pcba (component of LCD readout assembly). Remove and discard the damaged heating element.

The new service replacement heating element comes with a mini pcba attached to the wires. This mini pcba must be unsoldered and removed from the wires. Discard new mini pcba.

DO NOT attempt to remove the existing mini pcba from the LCD Readout Assembly of the heat gun!

Carefully solder the wires from the new heating element onto the existing mini pcba to the locations indicated below.

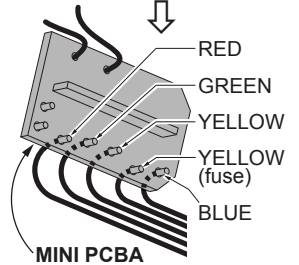

NOTE: Cord Clamp (9) secures cord jacket (6) in the Left Handle Halve (1) by two screws (10). One screw is placed inside the tool, through the front hole of the cord clamp as shown. The other screw is placed through the bottom most hole in the Right Handle Halve (2), then through the rear hole of the cord clamp.

FIG.	PART NO.	DESCRIPTION OF PART	NO. REQ.
1	-----	Left Handle Halve	1
2	-----	Right Handle halve	1
3	-----	◆ Switch Cover with external markings	1
4	31-44-0013	Soft Grip	1
5	-----	◆ Rubber Tool Rest	1
7	31-55-0031	Nose Cone	1
8	22-64-0037	Cord Set with Cord Protector	1
9	-----	◆ Cord Clamp	1
10	-----	◆ Pan Head Phillips Screw (Chrome)	6
12	14-50-0051	Motor/Fan Assembly	1
13	14-20-0042	Heating Element	1
16	-----	Logo Label	1
17	12-20-8987	Service Nameplate	1
18	-----	Warning Label (Not Shown)	1
21	14-46-0021	Repair Service Kit	1
22	14-38-0022	Handle Service Kit	1

21 ◆ 14-46-0021 Repair Service Kit				
Consists of:				
Fig.	Description of Part	Where Used	Color	Qty.
3	Switch Cover w/markings	Internal Switch	Black	1
5	Rubber Tool Rest	Handle Halves	Black	1
9	Cord Clamp	Cord Jacket	White	1
10	Pan Head Phillips Screw	Cord Clamp	Chrome	1
10	Pan Head Phillips Screw	Right Handle	Chrome	5