

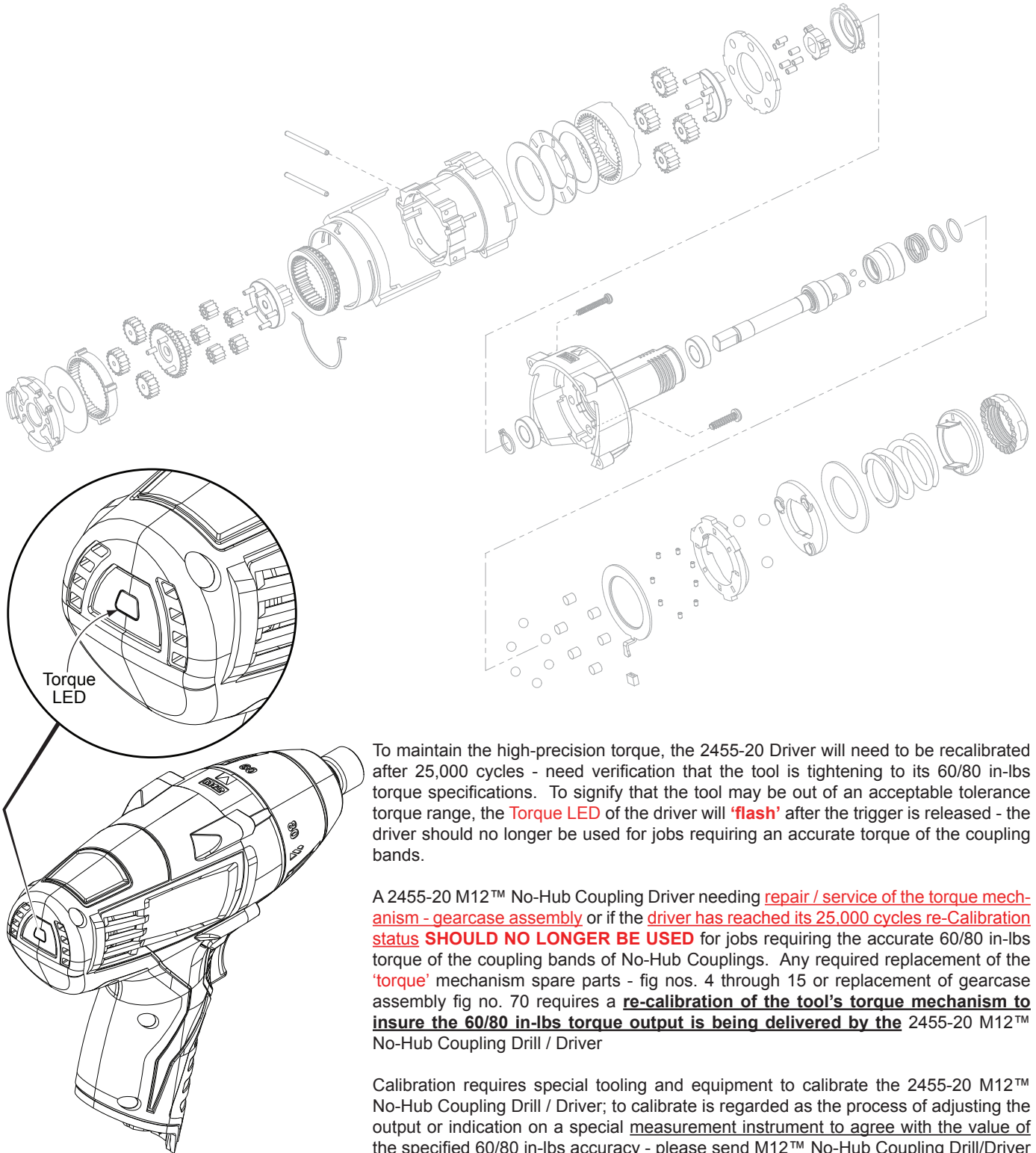

SERVICE PARTS LIST

BULLETIN NO.
54-06-2455

SPECIFY CATALOG NO. AND SERIAL NO. WHEN ORDERING PARTS		REVISED BULLETIN	DATE
Cordless M12™ No-Hub Coupling Driver-Drill			Feb. 2014
CATALOG NO. 2455-20	STARTING SERIAL NO. C34A	WIRING INSTRUCTION SEE PAGE 4	



To maintain the high-precision torque, the 2455-20 Driver will need to be recalibrated after 25,000 cycles - need verification that the tool is tightening to its 60/80 in-lbs torque specifications. To signify that the tool may be out of an acceptable tolerance torque range, the **Torque LED** of the driver will **'flash'** after the trigger is released - the driver should no longer be used for jobs requiring an accurate torque of the coupling bands.

A 2455-20 M12™ No-Hub Coupling Driver needing repair / service of the torque mechanism - gearcase assembly or if the driver has reached its 25,000 cycles re-Calibration status **SHOULD NO LONGER BE USED** for jobs requiring the accurate 60/80 in-lbs torque of the coupling bands of No-Hub Couplings. Any required replacement of the **'torque'** mechanism spare parts - fig nos. 4 through 15 or replacement of gearcase assembly fig no. 70 requires a re-calibration of the tool's torque mechanism to insure the 60/80 in-lbs torque output is being delivered by the 2455-20 M12™ No-Hub Coupling Drill / Driver

Calibration requires special tooling and equipment to calibrate the 2455-20 M12™ No-Hub Coupling Drill / Driver; to calibrate is regarded as the process of adjusting the output or indication on a special measurement instrument to agree with the value of the specified 60/80 in-lbs accuracy - please send M12™ No-Hub Coupling Drill/Driver needing repair/service of the torque mechanism or if the driver has reached its 25,000 cycles to **Milwaukee Electric Tool Corporation - 13135 West Lisbon Road - Brookfield, Wisconsin 53005 - Attention: After-Sales Service.**

MILWAUKEE ELECTRIC TOOL CORPORATION
13135 W. Lisbon Road, Brookfield, WI 53005
Drwg. 3