



## SERVICE PARTS LIST

BULLETIN NO.  
54-00-PEXE

SPECIFY CATALOG NO. AND SERIAL NO. WHEN ORDERING PARTS			REVISED BULLETIN	DATE
M18™ ForceLogic™ Hydraulic PEX Expander				Dec. 2015
CATALOG NO.	2633-20	SERIAL NUMBER	WIRING INSTRUCTION	
		H03A		

FIG.	PART NO.	DESCRIPTION OF PART	NO. REQ.
6		2.0" Expander Head Assembly	(1)
6a	34-40-0001	O-Ring	(1)
6b	34-40-0003	O-Ring	(1)
6c		2.0" Segment	(6)
6d		2.0" Expander Head Collar	(1)
FIG.	PART NO.	DESCRIPTION OF PART	NO. REQ.
6		2.5" Expander Head Assembly	(1)
6b	34-40-0002	O-Ring	(2)
6c		2.5" Segment	(6)
6d		2.5" Expander Head Collar	(1)
FIG.	PART NO.	DESCRIPTION OF PART	NO. REQ.
6		3.0" Expander Head Assembly	(1)
6b	34-40-0003	O-Ring	(2)

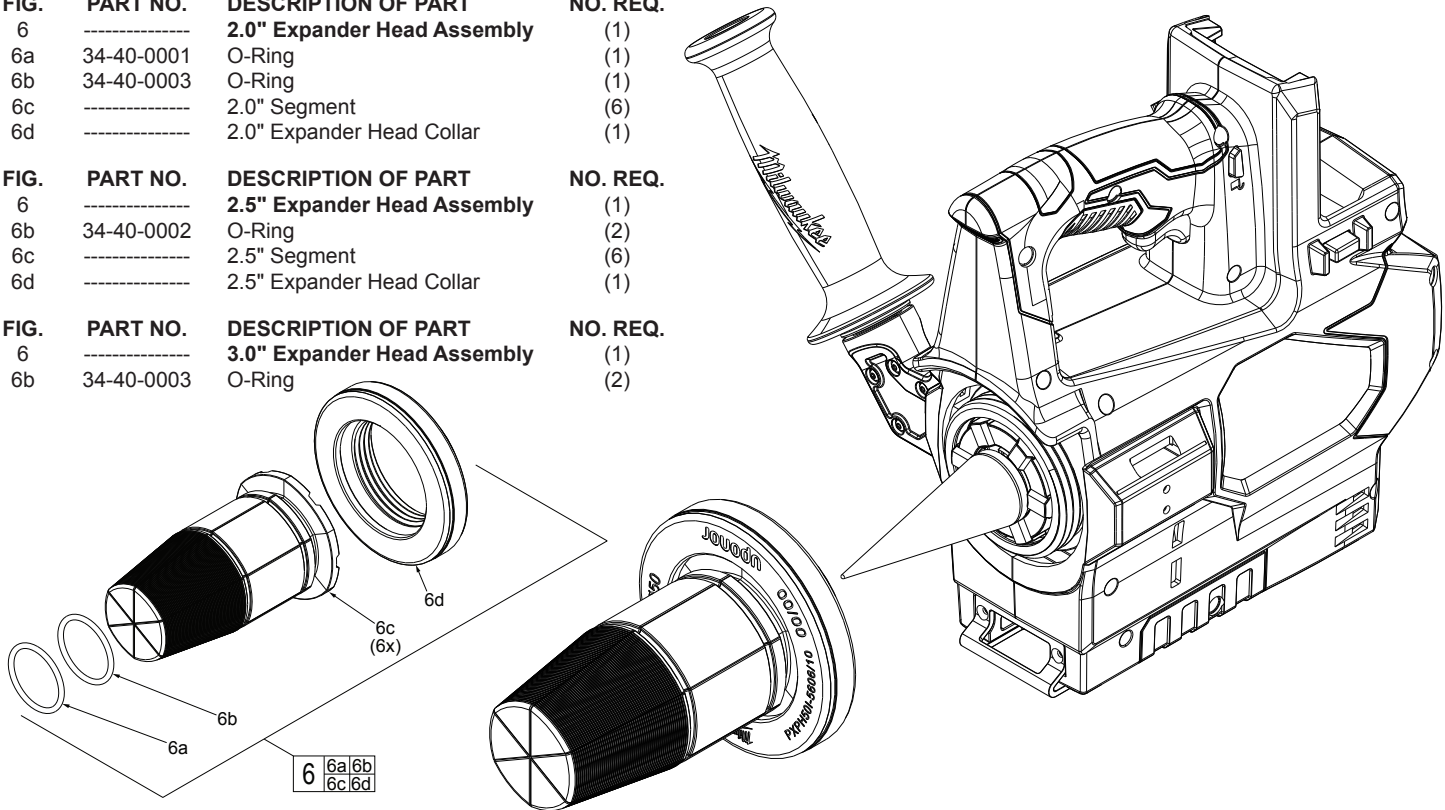

### Milwaukee Electric Tool: M18™ Force Logic™ Hydraulic PEX Expander and applicable Expander Head Assemblies

**Due to the combination of hydraulics and electronics in this tool,  
service can only be performed at this Milwaukee factory Central Repair Center:**

**MILWAUKEE ELECTRIC TOOL Central Repair  
1013 Sycamore Avenue • Greenwood, MS 38930-7277**

Please send your tool directly to this location for service.

If you have questions please contact Milwaukee Product Service at:

**Product Technical Support via phone at: 262.783.8642**

Or

**Via email at: [METProductSupport@milwaukeetool.com](mailto:METProductSupport@milwaukeetool.com)**

Disassembly is not recommended and could void the warranty.