

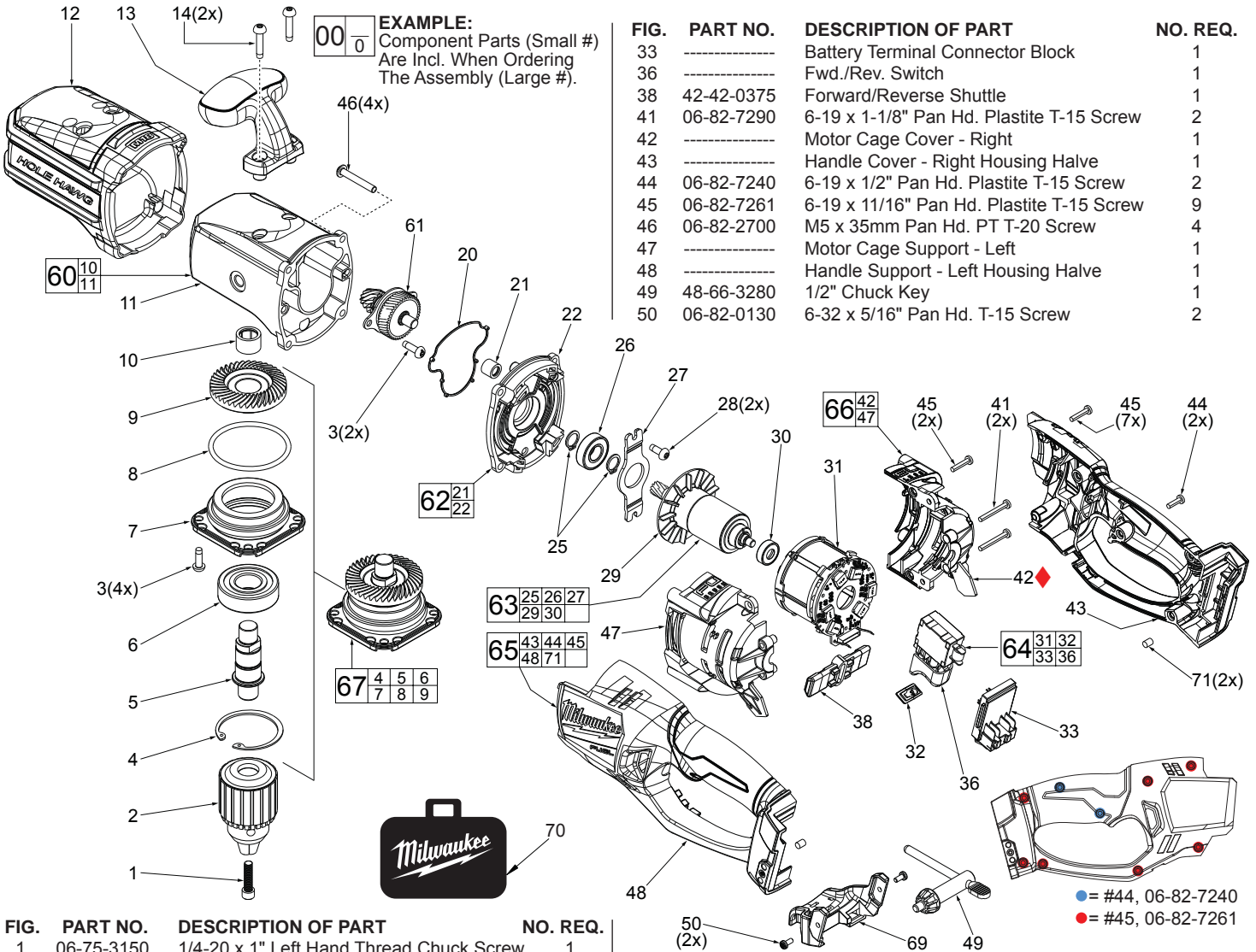

# SERVICE PARTS LIST

**BULLETIN NO.**  
**54-10-2700**

SPECIFY CATALOG NO. AND SERIAL NO. WHEN ORDERING PARTS		REVISED BULLETIN	DATE
<b>M18 FUEL™ 1/2" Hole-Hawg®</b>			Jan. 2015
CATALOG NO.	<b>2707-20</b>	STARTING SERIAL NO.	<b>G02A</b>
		WIRING INSTRUCTION <b>SEE PAGE 3</b>	



**EXAMPLE:**  
Component Parts (Small #)  
Are Incl. When Ordering  
The Assembly (Large #).

FIG.	PART NO.	DESCRIPTION OF PART	NO. REQ.
33	-----	Battery Terminal Connector Block	1
36	-----	Fwd./Rev. Switch	1
38	42-42-0375	Forward/Reverse Shuttle	1
41	06-82-7290	6-19 x 1-1/8" Pan Hd. Plastite T-15 Screw	2
42	-----	Motor Cage Cover - Right	1
43	-----	Handle Cover - Right Housing Halve	1
44	06-82-7240	6-19 x 1/2" Pan Hd. Plastite T-15 Screw	2
45	06-82-7261	6-19 x 11/16" Pan Hd. Plastite T-15 Screw	9
46	06-82-2700	M5 x 35mm Pan Hd. PT T-20 Screw	4
47	-----	Motor Cage Support - Left	1
48	-----	Handle Support - Left Housing Halve	1
49	48-66-3280	1/2" Chuck Key	1
50	06-82-0130	6-32 x 5/16" Pan Hd. T-15 Screw	2

FIG.	PART NO.	DESCRIPTION OF PART	NO. REQ.
1	06-75-3150	1/4-20 x 1" Left Hand Thread Chuck Screw	1
2	48-66-1381	1/2" Chuck	1
3	06-82-5411	10-24 x .625" Pan Hd. Tapt. T-25 Screw	6
4	-----	Retaining Ring	1
5	-----	Output Shaft	1
6	-----	Ball Bearing	1
7	-----	Output Mount Hub	1
8	34-40-2700	O-Ring	1
9	-----	Bevel Gear	1
10	-----	Needle Bearing	1
11	-----	Gearcase	1
12	45-12-0050	Insulated Boot	1
13	31-44-2717	Top Handle	1
14	05-88-9915	M5 x 25mm DG Pan Hd. T-25 Screw	1
20	43-44-0115	Gasket Seal	1
21	-----	Needle Bearing	1
22	-----	Diaphragm	1
23	23-94-2717	High Voltage Wire (Not Shown, see wiring diagram)	1
24	06-82-0165	M2.5 x 0.45 Tapt. Screw (Not shown, see wiring dia.)	1
25	34-60-0610	Snap Ring	2
26	02-04-1204	Ball Bearing	1
27	-----	Pinion Bearing Plate	1
28	06-82-5314	10-24 x .5" Pan Hd. Taptite T-25 Screw	2
29	-----	Rotor	1
30	02-04-0645	Ball Bearing	1
31	-----	Stator Assembly with PCBA	1
32	-----	LED Assembly	1

FIG.	PART NO.	DESCRIPTION OF PART	NO. REQ.
59	12-20-2717	Service Nameplate (Not Shown)	1
60	14-30-1005	Gearcase Assembly	1
61	14-29-2000	Intermediate Gear Assembly	1
62	14-13-0030	Diaphragm Assembly	1
63	16-01-2400	Rotor Assembly	1
64	14-20-2717	Electronics Assembly	1
65	31-44-2718	Housing Assembly	1
66	23-16-0285	Motor Cage Assembly	1
67	14-29-0125	Output Assembly	1
69	43-72-0260	Chuck Key Holder Assembly	1
70	48-55-3565	FUEL™ Contractor Bag - Large	1
71	45-30-1000	Rubber Slug	2

**IMPORTANT!**  
To prevent damage to the High Voltage Wire Assembly #23, see service note on page 3 prior to removing the Motor Cage Cover #42.