

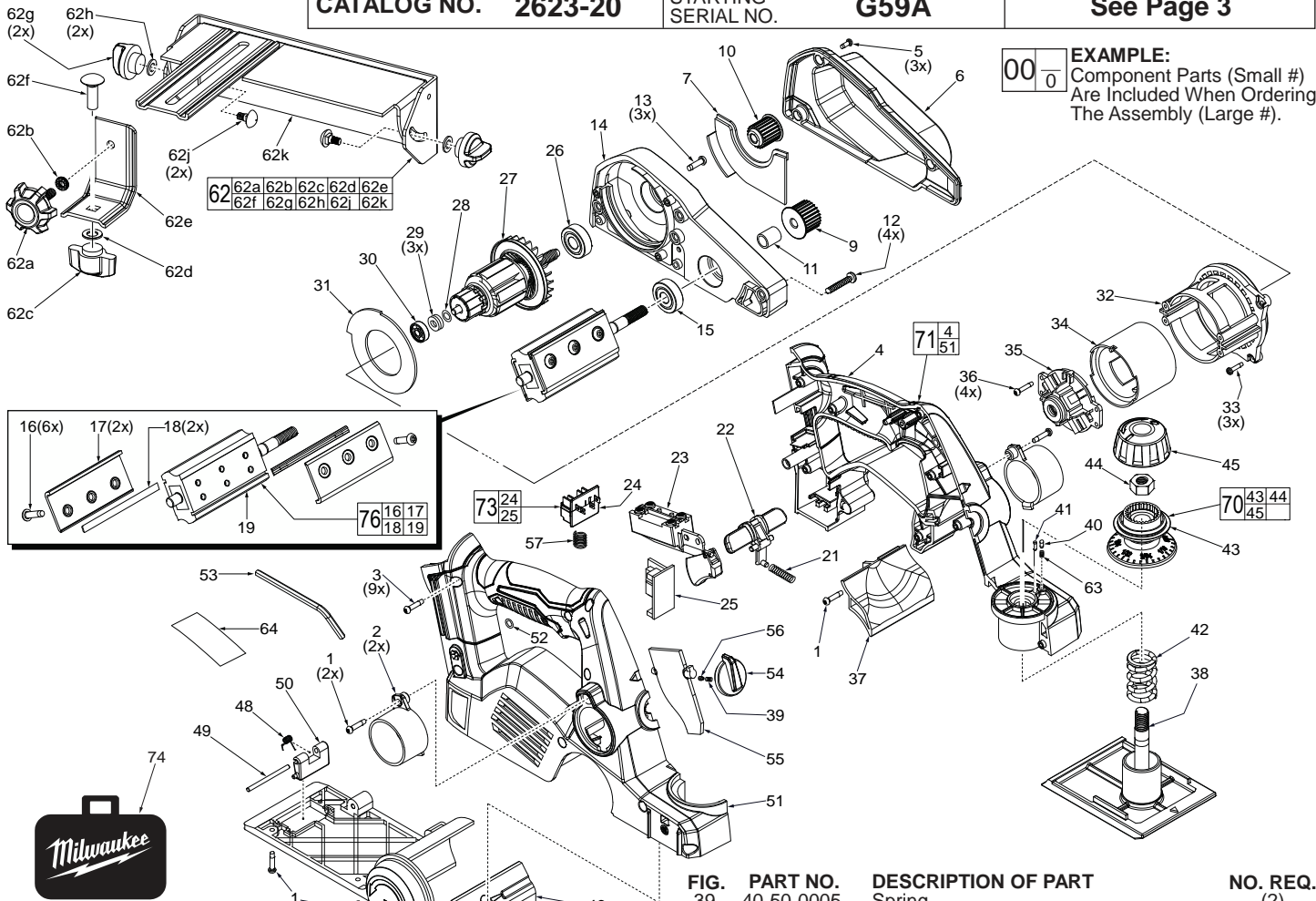

SERVICE PARTS LIST

BULLETIN NO.
54-49-2610

SPECIFY CATALOG NO. AND SERIAL NO. WHEN ORDERING PARTS		REVISED BULLETIN	DATE
CORDLESS M18™ PLANER			June 2015
CATALOG NO. 2623-20	STARTING SERIAL NO. G59A	WIRING INSTRUCTION See Page 3	



EXAMPLE:
Component Parts (Small #)
Are Included When Ordering
The Assembly (Large #).

FIG.	PART NO.	DESCRIPTION OF PART	NO. REQ.
1	06-82-2025	M3.5 x 15 Pan Hd. Plastite T-15 Screw	(6)
2	42-04-0020	Dust Adapter	(2)
3	06-82-7470	6-19 x 11/16" Pan Hd. Plast. T-15 Screw	(9)
4	-----	Left Handle Halve - Support	(1)
5	05-81-0010	M3 x .5 Pan Hd. Tapitite T-10 Screw	(3)
6	42-92-0011	Pulley Cover	(1)
7	42-92-0017	Scroll Cover	(1)
8	42-25-0031	Belt (Not Shown)	(1)
9	28-95-0022	Pulley - Driven	(1)
10	28-95-0024	Pulley - Driver	(1)
11	42-40-0018	Bushing	(1)
12	06-82-7326	8-16 x 1" Pan Hd. Plastite T-20 Screw	(4)
13	05-78-5316	M4 x 14mm Pan Hd. Tapitite T-20 Screw	(3)
14	44-66-0027	Side Plate	(1)
15	02-04-0535	Ball Bearing	(1)
16	06-75-0023	10-24 x .75 Button Hd. Mach. Screw-1/8 Hex	(6)
17	42-68-0011	Blade Clamp	(2)
18	42-26-0022	Cutting Blade	(2)
19	28-52-0010	Cutting Head	(1)
21	40-50-1760	Spring	(1)
22	42-42-0044	Switch Lock-Out	(1)
23	23-66-1000	On-Off Switch	(1)
24	-----	Battery Connector Block Assembly	(1)
25	-----	PCBA	(1)
26	02-04-1020	Ball Bearing	(1)
27	16-01-2623	Service Armature	(1)
28	45-36-2040	Armature Spacer	(1)
29	45-88-3225	Washer	(3)
30	02-04-1930	Ball Bearing	(1)
31	42-14-0017	Fan Baffle	(1)
32	44-34-0031	Motor Mount	(1)
33	05-81-1170	M3 x 12mm Pan Hd. Tapitite T-10 Screw	(3)
34	18-10-0300	Service Field	(1)
35	14-46-0029	Brush Card Assembly	(1)
36	06-82-6350	M3 x 16mm Pan Hd. ST T-10 Screw	(4)
37	42-14-0019	Top Air Flow	(1)
38	14-74-0101	Front Shoe Assembly	(1)

FIG.	PART NO.	DESCRIPTION OF PART	NO. REQ.
39	40-50-0005	Spring	(2)
40	44-60-0011	Clutch Click Pin	(1)
41	44-60-0013	Pin	(1)
42	40-50-0007	Compression Spring	(1)
43	42-76-0235	Adjustment Collar	(1)
44	06-55-0615	Hex Nut	(1)
45	31-12-0010	Adjustment Cap	(1)
46	42-14-0021	Bottom Air Flow	(1)
48	40-50-0009	Spring	(1)
49	44-60-0019	Pin	(1)
50	31-70-0102	Kickstand	(1)
51	-----	Right Handle Halve - Cover	(1)
52	34-40-0024	O-Ring	(1)
53	49-96-0051	1/8" Hex Key	(1)
54	43-98-0016	Dust Flap Knob	(1)
55	42-21-0010	Dust Flap	(1)
56	44-60-0021	Flap Knob Pin	(1)
57	40-50-1090	Spring	(1)
62	49-13-0030	Bevel Edge Guide Assembly	(1)
62a	44-60-0023	Attachment Knob	(1)
62b	44-90-0007	Ring	(1)
62c	44-60-0027	Width Adjustment Knob	(1)
62d	45-88-0011	Washer	(1)
62e	44-66-0041	Adjustment Plate	(1)
62f	06-14-0061	M6 x 12mm Bolt	(1)
62g	44-60-0034	Bevel Adjustment Knob	(2)
62h	45-88-0018	Washer	(2)
62j	06-14-0071	Bevel Adjustment Bolt	(2)
62k	-----	Edge Guide Plate Assembly	(1)
63	40-50-0802	Defent Spring Service	(1)
64	12-20-0009	Nameplate Dust Bag	(1)
65	42-16-2623	(Not Shown)	(1)
70	43-98-0076	Adjustment Knob Assembly	(1)
71	31-44-0029	Housing Assembly	(1)
72	14-74-0107	Rear Shoe Assembly with Needle Bearing	(1)
73	14-20-0033	Electronics Assembly	(1)
74	42-55-2623	Carrying Case	(1)
76	28-52-2623	Cutting Head Assembly	(1)

MILWAUKEE ELECTRIC TOOL CORPORATION
13135 W. LISBON RD., BROOKFIELD, WI 53005
Dwg. 1